

Installing Qtrac with Post Mount

A. Parts Checklist

Check to make sure all supplied parts and tools are accounted for:

1. Qtrac LCD/CPU Unit: This will include the LCD, CPU, one pre-installed low-profile USB flash drive, the Qdrive (large USB stick) with USB extension cable
2. Square Post Surface Mount
3. Station Lights with three screws (one per cashier station)
4. Qtrac Remote Control Units with AC adapter (one per cashier station)
5. Light Controller (one per cashier station)
6. One 5/64" Allen key (for Lights)

1



2



3



4



5



6



Installing Qtrac with Post Mount

B. Installing the Square Post Surface Mount

1. Following the Store Layout Plan, locate the desired location of the Monitor on the Service Counter. This may be marked with blue tape on the surface of the Counter.
2. Drill 4 pilot holes in the counter for the 4 wood screws (provided)
3. Using the four Square Post Mounting Screws, secure the Square Post Mount to the counter, making sure that the Monitor Mount faces the queue.



C. Attaching the Qtrac LCD/CPU to the Square Post Surface Mount

1. Mount the Qtrac LCD/CPU Unit onto the Post Monitor Mount by sliding the Qtrac LCD/CPU Unit onto the Post-Mount Assembly as shown on the right. The mount is secured using 2 screws and hex wrench in the parts bag, found with the Velcro patches, top box of the parts boxes.
2. Connect the power cord for the LCD, and the power adapters for the CPU and Soundbar into the power cord at the top of the post. Bundle and secure loose wires and cables, neatly and securely with Zip Ties. Ensure wires do not dangle.
3. Ensure the computer is straight and secure on the Velcro.
4. Make sure that the HDMI cable is securely connected to both the computer and the LCD.
5. Insert the power cord at the bottom of the post into an AC wall outlet or power strip below the counter.
6. **Do not plug in Qtrac into power until all remotes, controllers, and lights are installed (Step G). Ensure TV, CPU, and sound bar have power at that time.**

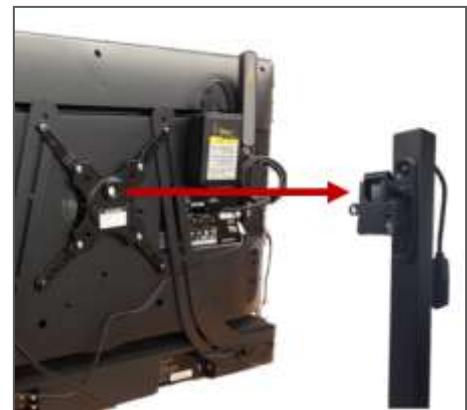

Installing Qtrac with Post Mount

D. Installing the Remote Control Units

1. Each Remote is marked to correspond to a specific station. Determine the correct location for each Remote Control and distribute all Remotes with their AC Adapters to their corresponding stations.
2. Plug the AC Adapter into an AC wall outlet or power strip.
3. Route the Remote Control AC Adapter through counter-top.
4. Connect the AC Adapter to the Remote Control. The Remote Control is now "ON".
5. Secure the AC wiring by threading through teeth on the back of the Remote.
6. Place a piece of Velco on the back of the Remote Control. Do not secure it to a surface but leave the back film in place to allow Gordmans staff to locate the Remote Control where they prefer.
7. Repeat Steps 2–6 for each remaining Remote Control.

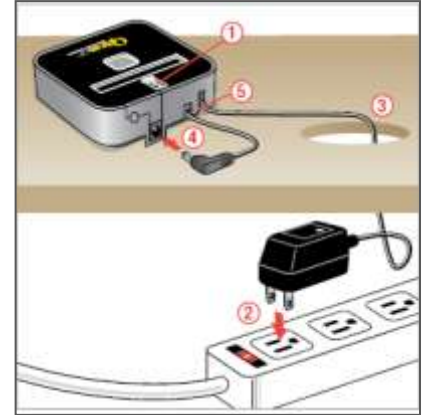

An alternative to using a power strip, is using the Light Controller. There are two power receptacles on the Light Controller, one designated for the Remote Control AC Adapter and the other for the Station Light Power Adapter. The diagram below illustrates the arrangement.

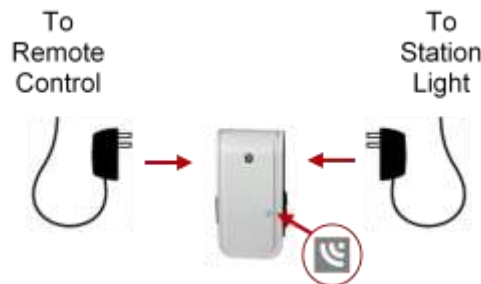

Make sure the Station Light AC Adapter plugs into the receptacle marked with the small wireless icon:



Installing Qtrac with Post Mount

E. Installing the Station Lights

At-A-Glance Diagram

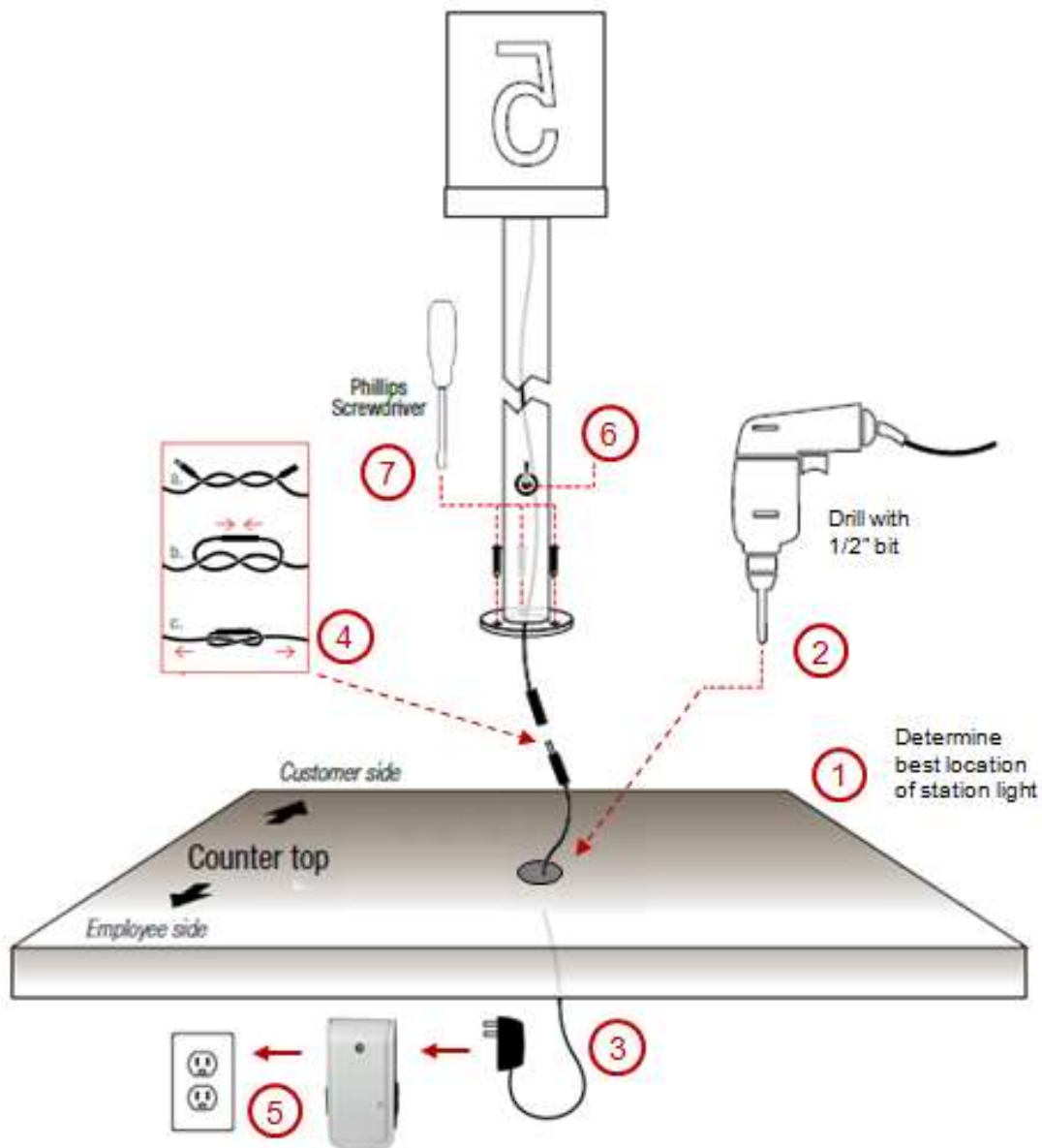

Installing Qtrac with Post Mount

F. Installing the Station Lights (*step-by-step*)

1. Determine best location of station lights: Both the pole and the button are to be installed at the register. Locate a position on the counter where electrical power is accessible below the light. There are some areas in counter corners where power is not accessible. Mount the pole as close as possible to the layout diagram. Please be sure to orient the power switch back toward the cashier when attaching the pole to the counter.



2. Drill 1 hole in the top of the counter using a 1/2" drill bit in the counter. This will permit the power cord to pass through the counter to the base of the station light. Drill 3 pilot holes for the wood screens to anchor the base of the station light to the counter.

3. Thread the small end of the Station Light AC Adapter from underneath the counter through the hole in the counter so that it meets up with the cord from the Station Light.

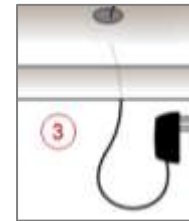

4. Connect and secure the AC wiring to the Station Light: *Securing the wires in this way will prevent slippage and pulling the connection apart.*

- Intertwine the two wires one over the other to create a knot.
- Connect the two ends together to complete the knot.
- Pull the wires in opposite directions to tighten.

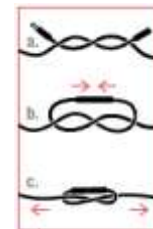

5. Connect the Light Controller: Plug the Station Light AC adapter into the Light Controller Module. **Make sure the AC Adapter plugs into the receptacle marked with the small wireless icon.**



Then plug the Light Controller Module into a power outlet.

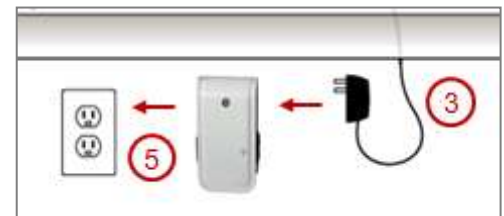

6. Test: Turn the light on by pressing the button on the side of the Light Controller Module. Ensure that all controllers are powered on with soft rocker switch and verify that the red light is on. If the light does not turn on, make sure that the switch on the Station Light Post is in the on (up) position.

7. Secure the Station Light: Reposition the Station Light over the pre-drilled holes in the counter making sure that the light is correctly positioned. Make sure that power cord freely moves through the hole in the counter and is not between the counter and the base of the station light. Secure with screws.



Installing Qtrac with Post Mount

G. Testing the System

1. After all Remotes have been plugged in, make sure that the Qtrac LCD, CPU and Soundbar are “ON” by verifying that their respective power LEDs glow. The LCD should display an image similar to that shown on the right..



2. Test the Qtrac by pressing the button on each Remote Control. Look for a corresponding Register number and directional arrow, message on bottom of screen (“Please proceed to Register X”), alert tone and audio message announced, and station light flashing to confirm that all the electronics are working properly.



3. Adjust the volume on the TV to the desired level. The TV remote will control the TV volume.